

33

SPORT COUPE



SILVERTON
YACHT



33

SPORT COUPE

The Newest Thing Under The Sun, The Moon Or The Stars

While her inside helm brings the captain indoors, we have not forgotten the importance of the outdoors to your on-water enjoyment. The cherry-accented Thirty Three Sport Coupe combines the convenience of a deckhouse with the alfresco experience of an Express. Full-view sliding double-doors form the cabin's aft bulkhead, allowing light, air, and guests unobstructed passage into the salon. The screened side windows open. Set in the hardtop, our standard VistaAire powered sliding glass panel lets in the sun, the moon, or the stars. The main cabin features a sleeper sofa for two, an entertainment center area, and a galley with standard microwave, cooktop, and undercounter refrigerator/freezer. A spacious master stateroom includes a double bed, under-mattress and drawer storage, and a cedar-lined wardrobe. The second stateroom is furnished with a double berth, cedar hanging locker, and standup changing area. The deep-vee Donald Blount hull delivers sparkling performance and a soft, dry ride. If you've dreamed of exploring a river, taking crabs from a tidal flat, following an old canal-boat route, or just cruising into town for lunch — the 33 Sport Coupe is worth your serious consideration.





33SC STANDARD EQUIPMENT

DECK FEATURES

Anchor Locker
Anchor Roller w/Flange
Bow Pulpit
1" Bow Rails
316L Stainless Steel Hardware
Cockpit Dunnage Box
Dockside Water Connection
Molded-In Diamond Non-Skid
Mooring, Quarter and Spring Cleats
Swim Platform w/Ladder
Tempered Safety Glass
Walk-Thru Transom

CABIN AMENITIES

Certified Marine Sanitation System
Cherry Cabinetry
Cockpit Sliding Doors
Custom Blinds
Designer Curtains
Designer Bedspreads
Designer Accent Pillows
Dinette Storage
Entertainment Center
Innerspring Mattress – Master Stateroom
Lower Helm Station w/Full Instrumentation
100% Nylon Scotchgard®-Protected Carpeting
UltraLeather™ Helm Seat
VistaAire Powered Sunroof
Wardrobe Lockers (2)
Window Screens

ELECTRICAL EQUIPMENT

AC/DC Converter
Batteries – Deep Cycle Marine
Circuit Breakers (12V)
Circuit Breakers (120V)
Color-Coded Harnessed Wiring System (12V)
Dockside Electrical Connection w/Cord
(1@30 amp – 120V)
GFCI System
Lighting – Interior (12V)
Lighting – Courtesy (12V)
Lights – Zoned Controls
Lights – Navigation (COLREGS)
Polarity Indicators
High Quality Tinned, Stranded Copper Wiring

SAFETY EQUIPMENT

Anti-Fouling Bottom Paint
Ball Valves on Underwater Thru-Hulls
Battery Safety Switches
Battery Safety Trays
Bonding System
Carbon Monoxide Detector
Dual Horns
Engine Alarms
Fire Extinguishing System
Parallel Start Switch

MECHANICAL

Acoustic and Thermal Insulation
Aquamet®Stainless Steel Propeller Shafts
Dripless Shaft Seals
Dual Lever Throttle and Transmission Control
Engine Hourmeter
Engine Exhaust Mufflers
Fuel Gauge – Electric
Fuel Lines – Flexible USCG Type 1
Fuel/Water Separators
Holding Tank
Hydraulic Steering
Manganese Bronze Rudders
Manganese Bronze Struts
Propellers
Pressurized Water System
Saddle Fuel Tanks
Shower Sump Pump – Auto
Trim Tabs
Vinylester Skin Coat
Water/Holding Tank Monitors

GALLEY

Corian®Countertops
Microwave
Range – 1 Burner Electric
Refrigerator/Freezer – 110V-12V

HEAD

Electric Head
Extra Storage
Faucet/Shower Wand
Fiberglass Countertops
Medicine Cabinet
Waterproof Outlet

OPTIONAL EQUIPMENT

Air-Conditioning – 3 Zones
Anchor Windlass
Anchor Windlass Chain
Bow Thruster
Electronic Controls (Diesel Only) – Glendinning
Electronics Packages
Entertainment Package – Includes:
AM/FM Single CD Stereo – Salon
Stereo Speakers – Salon/Cockpit
20" Flat Panel TV w/DVD – Salon
15" Flat Panel TV w/DVD – Stateroom
* Telephone Jacks
* Cable TV Hook-ups
* Glomex®TV/FM Antenna
Exterior Carpet
Generator – 6.0 EOD Diesel w/Sound Shield
Generator – 5.0 ECD Gas
Icemaker – Cockpit
Interior Carpet Runners
Linen Package
Macerator (Standard w/Par Quiet®Flush Fresh Water Head)
Maintenance Package – Includes:
Internal Sea Strainers
Oil X-Change-R®System
Washdown - Fresh Water - Bow
Washdown - Fresh Water - Aft
Washdown - Raw Water - Aft
Marine Pac – Includes:
Anchor and Ground Tackle
Boat Hook
Dock Lines
Fenders w/Lines
Hand Held Fire Extinguishers
Flare Kit
Floating Device
Life Vest
Par Quiet®Flush Fresh Water Head
Refrigerator – Cockpit
Remote Spotlight
Rod Holders (4)
UltraLeather™Sofas
Windshield Cover

* Available only in entertainment package

SPECIFICATIONS

Length Overall	32'7"	9.93 m
Waterline Length	28'3"	8.61 m
Beam	12'8"	3.86 m
Draft	30"	0.76 m
Deadrise	14°	
Approx. Wt. (Dry)	6,300 lb	7,393 kg
Fuel Capacity	208 gal	787 L
Water Capacity	82 gal	310 L
Holding Tank Cap.	30 gal	114 L
Headroom	6'6"	1.98 m
Sleeping Capacity	6	
Clearance Ht – (DWL no light)	12'1"	3.68 m
Power Options - GAS:		
Twin Crusader 5.0L MPI	275 HP	205 KW
Twin Crusader 6.0L MPI	375 HP	280 KW
Power Options - DIESEL:		
Twin Yanmar 6LPA-STP	315HP	235 KW

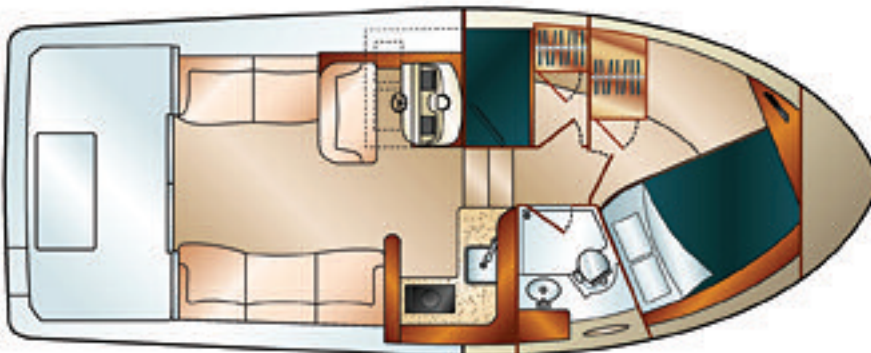

Optional generator may not power all systems concurrently. Photographs and floorplans may contain options or other features not covered by the base price. Silverton reserves the right to make changes to standard or optional equipment list or to what is shown in visual representations of its models in advertising and sales materials. Silverton may do so at any time and without prior notice. Silverton also reserves the right to make such changes without incurring any obligation.



**SILVERTON
YACHT**

PO Box 702
Egg Harbor City, NJ USA 08215
P: 609-965-2300 F: 609-965-3517
www.silverton.com

Sales Email: sales@silverton.com
Service Email: service@silverton.com

9/2012